

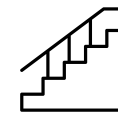

BYTOVÝ DOM

A



PODLAŽIE

1.NP

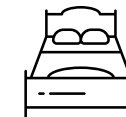

POČET IZIEB

2

PÔDORYS

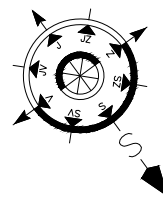
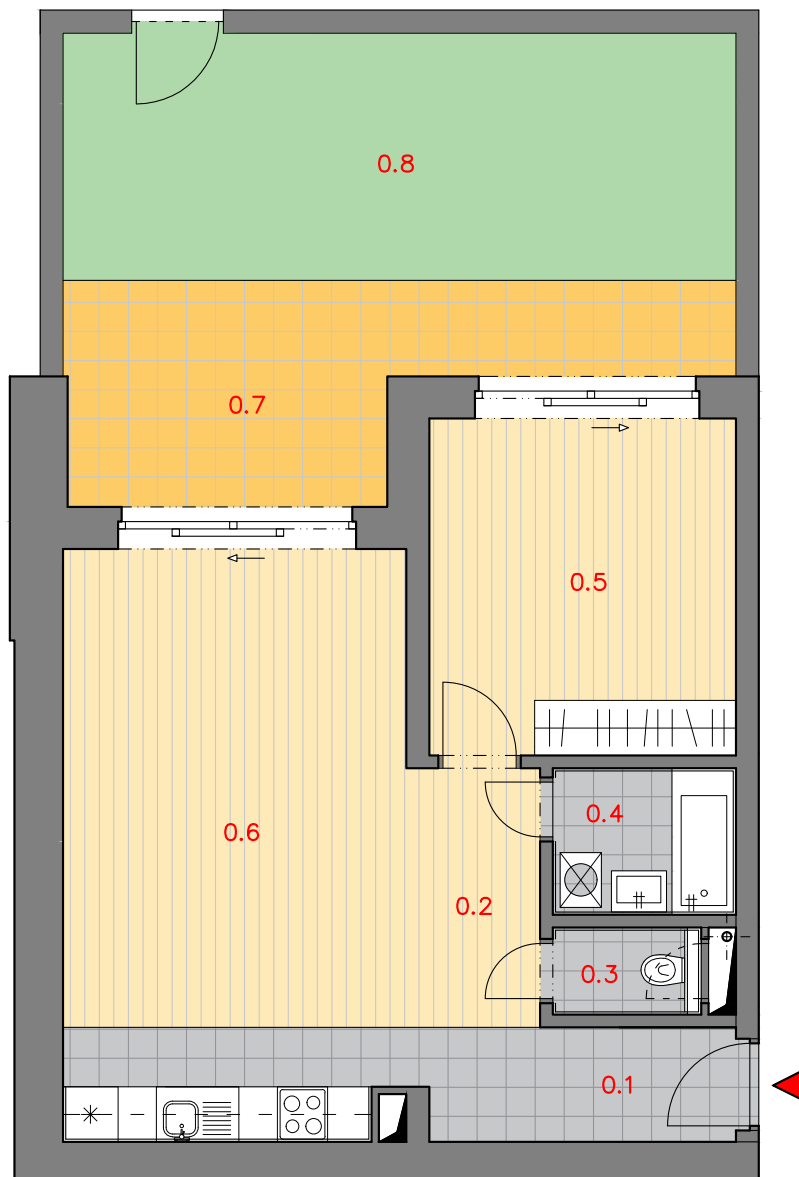

Výmery miestností

| | | |
|----|--------------------------|----------------------|
| 01 | Predsieň | 4,35 m ² |
| 02 | Chodba | 4,13 m ² |
| 03 | WC | 1,54 m ² |
| 04 | Kúpeľňa | 3,20 m ² |
| 05 | Spálňa | 12,33 m ² |
| 06 | Obývacia izba s kuchyňou | 24,02 m ² |

Úžitková plocha bytu 49,57 m²

| | | |
|----|--------------|----------------------|
| 07 | Terasa | 12,69 m ² |
| 08 | Predzáhradka | 19,85 m ² |

Pivnica

Kontakt na predajcu:

Ing. Peter Kollár

0917 449 563

Maroš Chavko

0908 338 119



info@solnypotok.sk